

vtech[®]

User's Manual

Melody Meadow[™]



© 2002 VTech
Printed in China
91-01548-000 (美)

Dear Parent:

At VTech® we know that a child has the ability to do great things. That's why all of our electronic learning products are uniquely designed to develop a child's mind and allow them to learn to the best of their ability. Whether it's introducing numbers and letters, identifying colors and shapes, or stimulating senses with lights and music, all VTech® infant and toddler learning products encourage your child's natural growth and discovery skills. When it comes to providing electronic learning products that enlighten, entertain and develop minds, at VTech® we see the potential in every child.

INTRODUCTION

Thank you for purchasing **VTech® Melody Meadow™** learning toy! This product is one of a family of high quality electronic learning toys. We at **VTech®** are committed to providing the best possible products to entertain and educate your child. Should you have any questions or concerns, please call our Consumer Services Department at 1-800-521-2010 in the U.S. or 1-800-267-7377 in Canada.

The **VTech® Melody Meadow™** is an interactive musical toy for toddlers 6 months and up. All the little critters are playing in the pond splishin' and a splashin' while they play their tunes. Watch them come to life as they spin around the twinkling waterfall. The style of music and the instrument sounds will change when you press on any of the four little critters. Toddlers can also create their own musical number with the colorful piano keyboard. Jam it, spin it, rock it, join us and sing along!

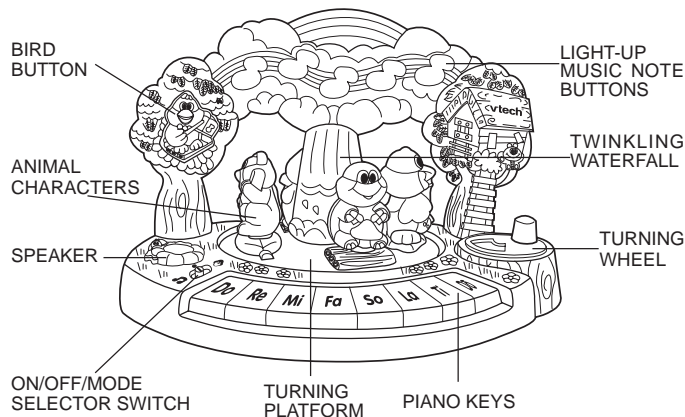

2

INCLUDED IN THIS PACKAGE

1. One **VTech® Melody Meadow™**
2. One instruction manual

WARNING: All packing materials, such as tape, plastic sheets, wire ties and tags are not part of this toy, and should be discarded for your child's safety.

BATTERY INSTALLATION

1. Make sure the unit is turned **OFF**.
2. Locate the battery cover on the bottom of the unit. Use a coin or screwdriver to loosen the screw.
3. Install 3 new "AA" (UM-3/LR6) batteries following the diagram inside the battery box. (The use of new alkaline batteries is recommended for maximum performance.)
4. Replace the battery cover and tighten the screw to secure the battery cover.

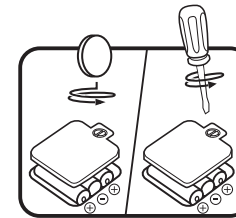

3

BATTERY NOTICE

- Install batteries correctly observing the polarity (+, -) signs to avoid leakage.
- Do not mix old and new batteries.
- Do not use batteries of different types.
- Remove exhausted or new batteries from the equipment when the unit will not be used for an extended period of time.
- Do not dispose of batteries in fire.
- Do not attempt to recharge ordinary batteries.
- The supply terminals are not to be short-circuited.
- Only batteries of the same and equivalent type as recommended are to be used.

WE DO NOT RECOMMEND THE USE OF RECHARGEABLE BATTERIES.

NOTE: If for any reason the program/activity stops working, please follow these steps:

1. Turn the unit **OFF**.
2. Interrupt the power supply by removing the batteries.
3. Let the unit stand for a few minutes, then replace the batteries.
4. Turn the unit **ON**. The unit should now be ready to play again.

If the problem persists, please call our Consumer Services Department at 1-800-521-2010 in the U.S. or 1-800-267-7377 in Canada, and a service representative will be happy to help you.

TO BEGIN PLAY

1. To turn the unit **ON**, slide the **ON/OFF/MODE SELECTOR SWITCH** to the **MELODY MODE** (🎵) or the **FREE PLAY MODE** (🎮) position.

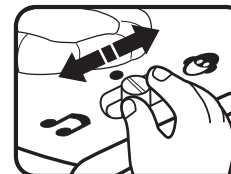

2. To adjust the volume, slide the **VOLUME CONTROL SWITCH** located on the bottom of the unit to the (🔊) position for **LOW VOLUME** or the (🔊) position for **HIGH VOLUME**.

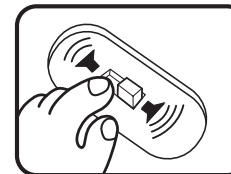

3. To turn the unit **OFF**, slide the **ON/OFF/MODE SELECTOR SWITCH** to the **OFF** (●) position.



ACTIVITIES

A. Free Play Mode

1. Slide the **ON/OFF/MODE SELECTOR SWITCH** to the **FREE PLAY MODE** (🎮) position. You will hear a playful sung song. The lights will flash randomly with the sound while the animals spin around the waterfall.

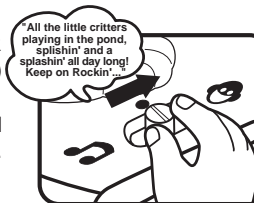

2. Press the **ANIMAL CHARACTERS** to hear fun phrases related to the style of music they each play, followed by one of two pre-programmed melodies. The lights will flash randomly with the sound while the animals spin around the waterfall. Press the animal characters while a melody is playing to hear the instrument sound take over playing the melody.

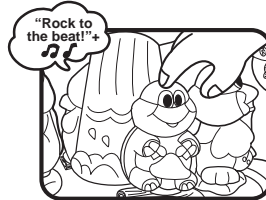

3. Press the **BIRD BUTTON** to hear a bird sound effect followed by a random melody. The lights will flash randomly with the sound while the animals spin around the waterfall. Press the bird button while a melody is playing to hear the bird sound play over top of the melody.

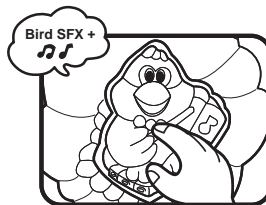

4. Press the **PIANO KEYS** to hear individual piano notes. The corresponding music note will light up while the animals spin around the waterfall.

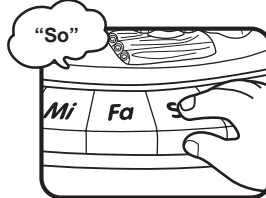

5. Press the **LIGHT-UP MUSIC NOTE BUTTONS** to hear sound effects. The corresponding music note will light up while the animals spin around the waterfall. Press one of the light-up music note buttons while a melody is playing to hear the sound effect play over top of the melody.

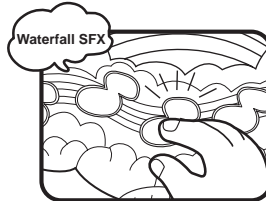

6

6. Turn the **TURNING WHEEL** to hear the sung song. The lights will flash randomly with the sound while the animals spin around the waterfall. When a melody is playing, turn the wheel quickly to increase the tempo of the melody or turn the wheel slowly to decrease the speed of the melody. Change the direction of the turning wheel to change the direction of the spinning animals.

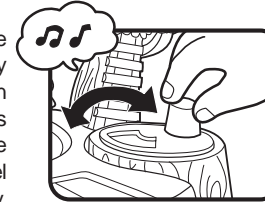

7. If there is no input to the unit after approximately ten seconds, you will hear the sung song. If there is no input after another ten seconds, you will hear "Rock to the beat" followed by a short tune. The unit will automatically power-down. The unit can be turned on again by pressing any button.

B. Melody Mode

1. Slide the **ON/OFF/MODE SELECTOR SWITCH** to the **MELODY MODE** () position. You will hear the first part of the sung song. The lights will flash randomly with the sound while the animals spin around the waterfall.



2. Press the **ANIMAL CHARACTERS** to hear a related sound effect followed by one of two pre-programmed melodies. The lights will flash with the sound while the animals spin around the waterfall. Press the animal characters while a melody is playing to hear the sound effect play over top of the melody.

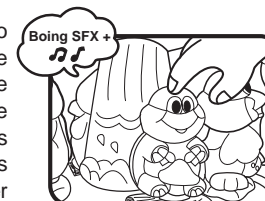

7

3. Press the **BIRD BUTTON** to hear a bird sound effect followed by the sung song. The lights will flash randomly with the sound while the animals spin around the waterfall. Press the bird button while a melody is playing to hear the bird sound effect play over top of the melody.



4. Press the **PIANO KEYS** to hear short counting tunes played with a variety of instruments. The music notes will light up with the short tune while the animals spin around the waterfall.

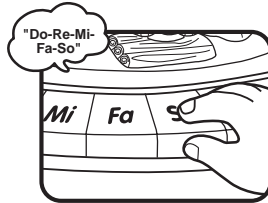

5. Press the **LIGHT-UP MUSIC NOTE BUTTONS** to hear pre-programmed melodies. The lights will flash randomly with the sound while the animals spin around the waterfall.

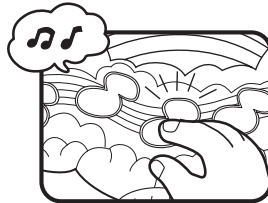

6. Turn the **TURNING WHEEL** to hear sound effects. The lights will flash randomly with the sound while the animals spin around the waterfall. When a melody is playing, turn the wheel quickly to increase the tempo of the melody or turn the wheel slowly to decrease the speed of the melody. Change the direction of the turning wheel to change the direction of the spinning animals.

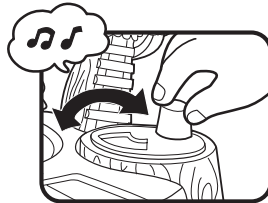

8

7. If there is no input to the unit after approximately ten seconds, you will hear a short part of the sung song. If there is no input after another ten seconds, you will hear another part of the sung song. The unit will automatically power-down. The unit can be turned on again by pressing any button.

PRE-PROGRAMMED MELODIES:

Frog

- Three Blind Mice
- Where Has My Little Dog Gone?

Duck

- Danny Boy
- Farmer in the Dell

Turtle

- Minuet in G
- Rondo Alla Turca

Beaver

- Clementine
- Chicken Reel

9

SUNG SONG LYRICS:

All the little critters playing in the pond,
splishin' and a splashin' all day long!
Keep on rockin'...
Keep on rockin'...
Jam it, spin it, rock it, join us and sing along!

CARE AND MAINTENANCE

1. Keep the unit clean by wiping it with a slightly damp cloth.
2. Keep the unit away from direct sunlight and heat source.
3. Remove the batteries when the unit is not in use for an extended period of time.
4. Do not drop the unit on hard surfaces and do not expose the unit to moisture or water.

IMPORTANT NOTE:

Creating and developing toddler products is accompanied by a responsibility that we at **VTech®** take very seriously. We make every effort to ensure the accuracy of the information, which forms the value of our products. However, errors sometimes occur. It is important for you to know that we stand behind our products and encourage you to call our Consumer Services Department at 1-800-521-2010 in the U.S. or 1-800-267-7377 in Canada with any problems and/or suggestions that you might have. Our service representative will be happy to help you.

NOTE:

This equipment generates and uses radio frequency energy and if not installed and used properly, that is, in strict accordance with the manufacturer's instructions, it may cause interference to radio and television reception. It has been type tested and found to comply within the limits for a Class B computing device in accordance with the specifications in Sub-part J of Part 15 FCC Rules, which are designed to provide reasonable protection against such interference in a residential installation. However, there is no guarantee that interference will not occur in a particular installation. If this equipment does cause interference with radio or television reception, which can be determined by turning the equipment off and on, the user is encouraged to try to correct the interference by one or more of the following measure:

- Reorient the receiving antenna
- Relocate this product with respect to the receiver
- Move this product away from the receiver